

State of Georgia, Fulton County.

This indenture made this 22nd day of July, A.D. 1898, between Mrs. E. M. Lawson, widow, of the city of Pensacola, Florida, of the first part, and William Fisher of the same place or trustee for Helen M. Fisher, Robert Singleton, Walter Singleton, Kate Lawrence, John Livingston and Adelle Singleton of the second part, witnesses: that the said party of the first part, for and in consideration of the love and affection which the said party of the first part bears to the said Helen M. Fisher, Robert Singleton, Walter Singleton, Kate Lawrence, John Livingston and Adelle Singleton, and also in consideration of the sum of Five Dollars heretofore paid at or before the execution and delivery of these presents, and for other good and valuable considerations, the receipt whereof is hereby acknowledged, has granted, bargained, sold, aliened, released, conveyed and confirmed, and of these presents does grant, bargain, sell, alien, release, convey and confirm unto the said party of the second part, and to his heirs and assigns, forever, the following described real estate situated in the 20th District S.W. in the county of Geneva, State of Georgia, to wit:

Beginning at a stake on Central Railroad, as shown by the plat of survey of the lands of Thomas Ketchum, deceased, recorded on the 15th day of December 1869, in the minutes of the Superior Court of said Geneva county, on folios 385 and 386, and running thence north 24 degrees west 50.10 chains to a pine, thence north 4 degrees west 50 chains to black oak, thence north 58 degrees west 5.50 chains to stake, thence north 34 degrees west 66.50 chains to stake, thence north 40 degrees west 38 chains to corner on creek, thence following southward about 47 chains to where line bears east, thence south 12 degrees, west 78 chains to a stake, thence south 70 degrees west 14 chains to a gum stump, thence south 16 degrees west to stake just south of Central railroad, thence south 77 degrees west 60.75 chains to the point of beginning, containing nine hundred and eleven (911) acres, more or less, a plat of said lands being hereto attached and marked "Exhibit A," and made a part hereof.

To have and to hold all and singular the above granted premises, together with appurtenances, and every part thereof, unto the said party of the second part, his successors and assigns, forever in fee, upon trusts, never to be divided, and to and for uses

interests and purposes hereinafter limited, described and declared - that is to say, upon trust to receive the issues, rents and profits of the said premises, and apply the same to the use of said Helen M. Fisher during the time of her natural life, or to all the same, or said parts of second part, trustee or aforesaid, may deem best, or such terms or to him shall seem meet, and reinvest the proceeds in real estate or goods and productive stocks, bonds, notes or mortgages and receive the issues, rents and profits, interest or income, arising therefrom and apply the same to use of the said Helen M. Fisher during the term of her natural life, and after the death of the said Helen M. Fisher to convey by deed the said premises herein-after described, or in case the parts of the second part, trustee or aforesaid, shall have sold the same and re-invested the proceeds as herein provided, the real estate, stocks, bonds, notes or mortgages, or the case may be, in which such proceeds shall have been re-invested, to Robert Singleton, Walter Singleton, Kate Lawrence, John Singleton and Adell Singleton, share and share alike in fee.

In witness whereof, the parties to these presents have hereunto in ten chargeably set their hands and seals the day and year first above written.

Signed, sealed and delivered in presence of
 Mrs. E. Henderson
 Elliot W. Mathews, Ch. P. Fulton Co., Ga.

Mrs. E. M. Lawton, (Seal)
 Wm Fisher, (Seal)

to Mrs. E. M. Lawton

to Wm Fisher

Geo W. Andrews
 Est Biggs

LRD
 12C
 EWM
 Jul 27/98

LR 5
 \$3.00
 EML
 July 27/98

State of Georgia, Fulton County.

This day personally appeared before me the undersigned, Mrs. E. M. Lawton, to me well known to be the person described in and who execute of the foregoing deed of conveyance, and acknowledged to and before me, she executed the same of her own free will and deed for the uses and purposes therein expressed.

In testimony whereof, I have hereunto set my hand and affixed my official seal the 22nd day of July 1898.

Elliot W. Mathews.
 Ch. P. Fulton Co. Ga.

Mrs. E. M. Lawton

LRD
 12C
 EWM
 Jul 27/98

Recorded Aug 3, 1898
 W. M. Bryan, Clk.

(See page 439.)

Exhibit "A"

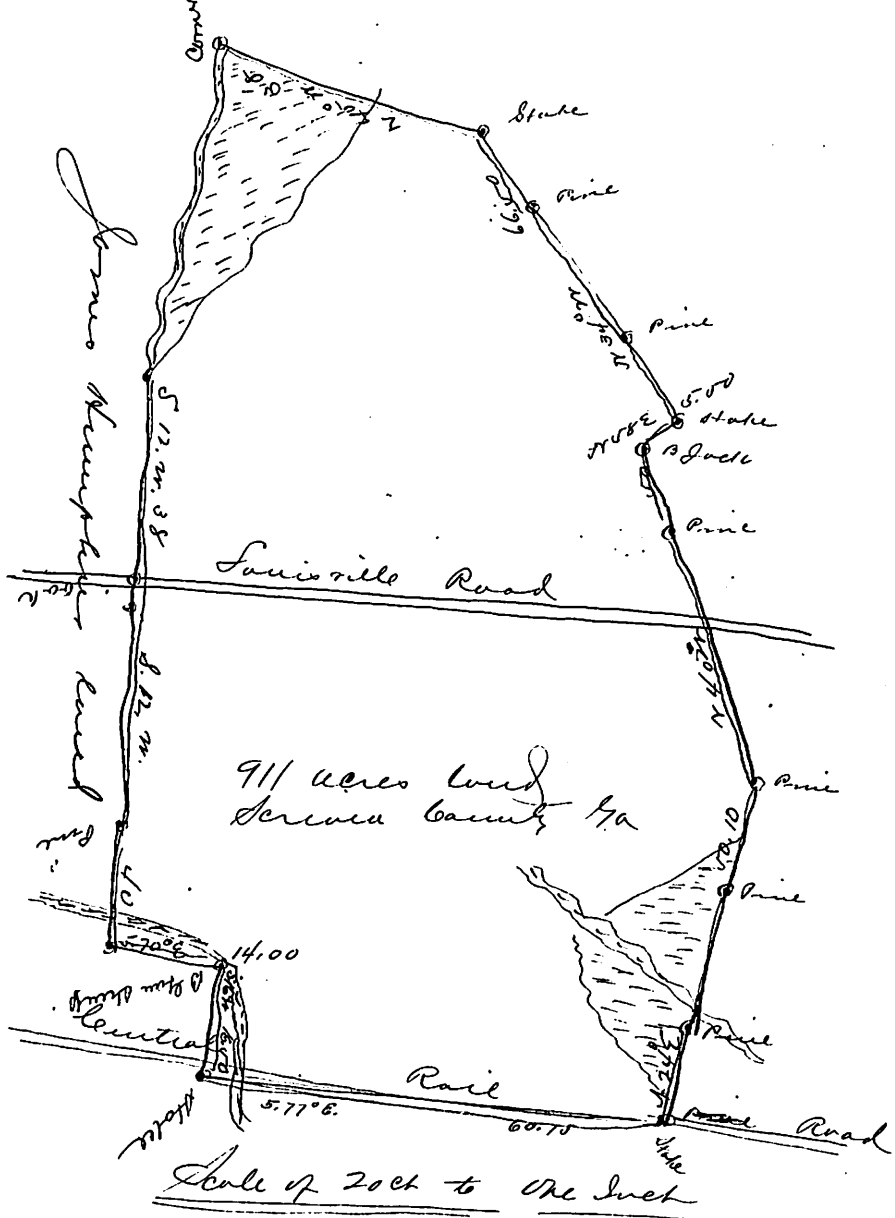

Creek North South

Witnesses:
Robt. Alston
W.P. Fulton Coly

Wm. E. M. Lawton

(See page 499)

Recorded Aug 3, 1898.
R. M. Bryan. Clk.

State of Georgia, Screven County:

This indenture, made the second day of August in the year of our Lord one thousand Eight hundred and Ninety eight, between William Patrick, Sheriff of the county of Screven of the first part, and E. C. Overstreet of the second part, witnesseth, that whereas, in obedience to a writ of fieri facias issued out of the ordinary's court of the county of Screven, at the suit of H. C. Parthen as guardian of E. W. Bonner, against A. D. Bonner and J. P. Bonner as administrators of John R. Bonner, deceased, the said William Patrick, Sheriff aforesaid, did lately seize the property herinafter described as the property of said A. D. Bonner and J. P. Bonner as administrators of said J. R. Bonner, and as the property of the estate of said John R. Bonner, deceased, and after notice served upon the said A. D. Bonner and J. P. Bonner as such administrators, and being duly and publicly advertised, agree